

RSA-CNB Cable Float Level Switch

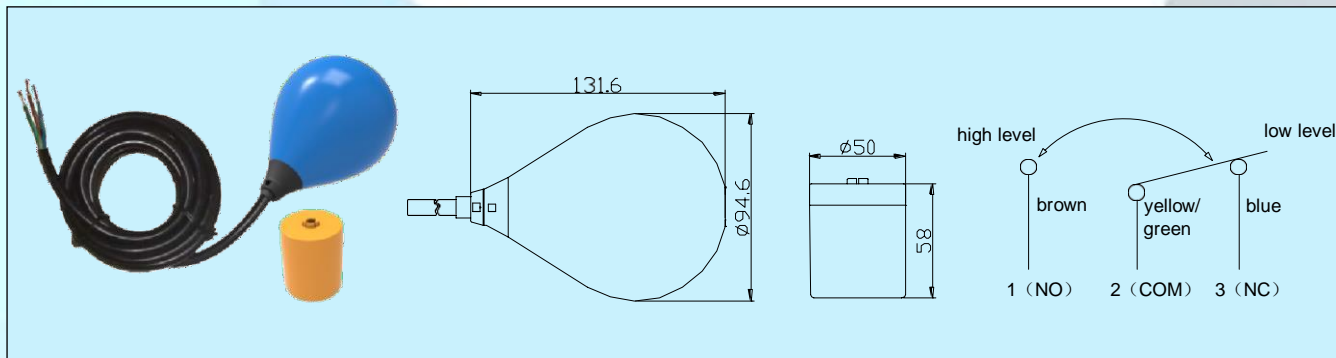

Applications & Features

- RSA-CNB level regulator is a float switch to control the pump, valve or alarm.
- Applied to various kinds of liquid (non-corrosive, high temperature, light density or turbulence)
- Special designed multi layers structure proves the inner chamber very well sealed, gives safe and reliable protection for inside mechanism
- Non-toxic polypropylene(PP) float body and CPE(VDE) cable, environmental friendly, even for daily life water
- The ball shape has no any edges, is particularly suitable for sewage water

Specifications

Contact: SPDT, 10A/250VAC

Electrical life: $>10^6$ cycles

Switch angle: $\pm 40^\circ$ ($\pm 5^\circ$)

Cable type and approvals:

Cable type	VDE Approval	CCC Approval
PVC Cable	H05VV-F3G1.0	RVV3x1.0
CPE(Rubber)Cable	H05RN-F3G1.0	YZW3x1.0

Operating temperature: 0~60°C

Storage temperature: -20~80°C

Weight: float: 300g; counterweight: 200g; cable: 90g/m (CPE), 80g/m (PVC)

Volume: 498cm³

Materials: float PP; counterweight: ABS

Protection: IP68

Max working pressure: 1.2 bar (12m water depth)

Approval: CE

Models

Model	RSA-CNB			Cable float level switch
Cable Length		03		3m
		05		5m
		10		10m
		15		15m
Cable Type			P	PVC
			C	CPE(Rubber)
Package			0	Carton Package
			1	Individual Package

Note: Carton package has 14 pcs/carton for 3/5m and 10 pcs/carton for 10/15m.

Connection

Please refer to the following wiring diagram. The label on the cable illustrates wiring descriptions.

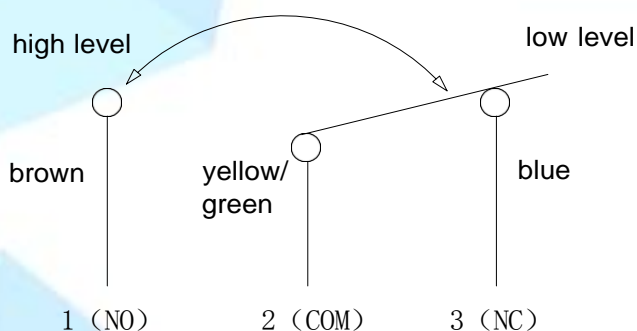

1. Yellow green and brown wires will connect at high level and disconnect at low level.
2. Yellow green and blue wires will connect at low level and disconnect at high level.

Installation

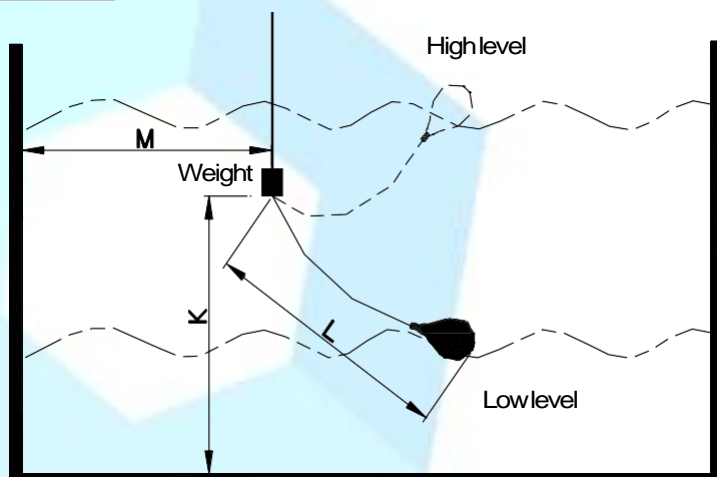

Figure 1

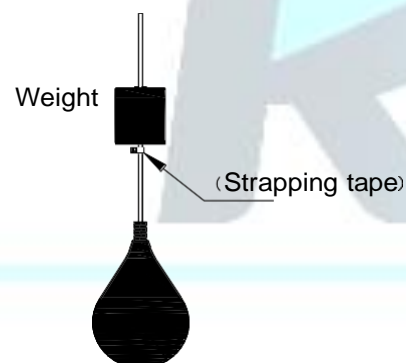

Figure 2

1. Shown as Fig. 1, the movement weight and float body installation requirements: $K > L$ and $M > L$, to prevent the float body to crash against side wall or bottom of tank, sink and result in failure of the float.
2. Shown as Fig. 2, feed the cable from the movement weight's bottom (the end with larger hole), push the movement weight to the prepared level. It will keep the position under normal application. But if anything else collide the weight, it may change the installed position. So customer may stick something like strapping tape right on this position to prevent the weight from falling down.

Attention

1. The position of the float body should be kept safe distance from the water outlet.
2. The position of the float body should be kept away from the water entry to prevent incorrect actuation of the switch.
3. It is NOT allowed to connect the cable with other cables for extending. If it is necessary, be sure to let the joint position always higher than the water level, to prevent short circuit, or seriously electricity accident.
4. The load of control line must be less than the switch contact capacity. It should be power OFF during installing and wiring, otherwise it will bring unpredictable conditions, and even damage the product.
5. The movement weight is very heavy, so it should be paid special attention to avoid collision or hurting someone.

Warranty

- It has limited warranty for eighteen (18) months after the production date.

RSA SENSORES - ATENDIMENTO



ESCANEAR O QR CODE COM A CAMERA DO CELULAR, PARA CHAMAR NO WHATS APP